



Sandringham Gardens, North Finchley, N12 0PL

£350,000 - Leasehold

A chain free, 2 double bedroom retirement apartment situated on the 3rd floor (top with lift) and located close to North Finchley High Road. This 850 sq ft flat boasts a bright 22ft reception room with large feature window and Juliet balcony, a 12ft kitchen with breakfast bar, built-in wardrobes to both bedrooms and gas central heating. The block is for the over 60's with an on-site warden, communal gardens and communal off street parking.

Lease: Approx. 96 years
Ground Rent: £50 per 6 months
Service Charge: £1670 per 6 months

- Over 60's development
- 3rd floor (top with lift)
- 22ft reception room
- Communal gardens
- Warden assisted
- Communal parking
- Chain free
- Close to North Finchley
- Barnet council tax band E

Floor Plan

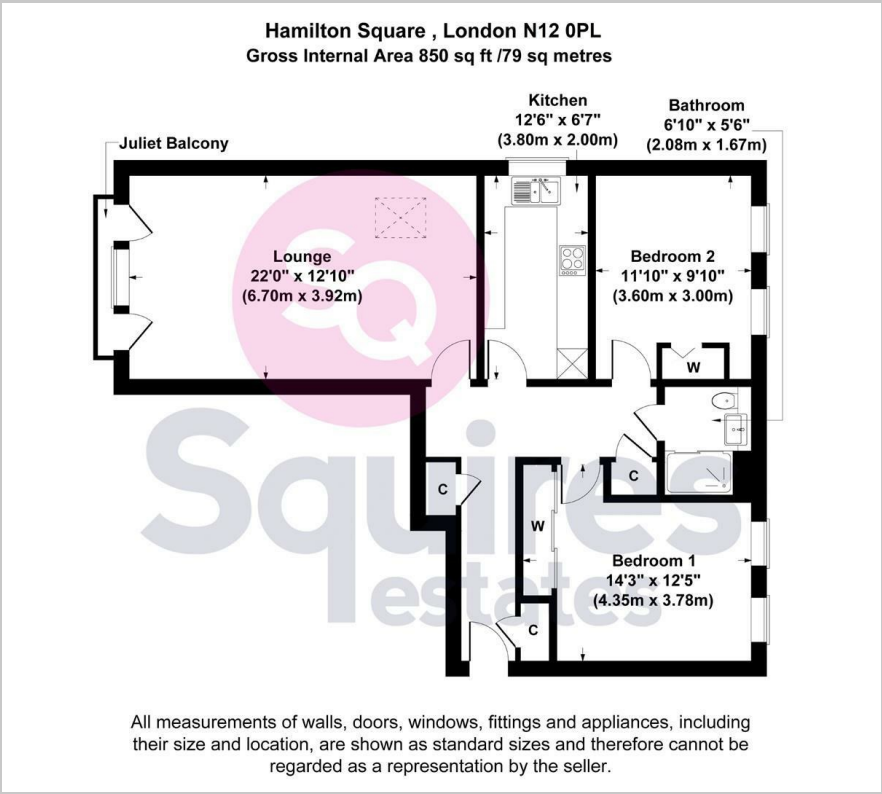

Area Map



Energy Efficiency Graph

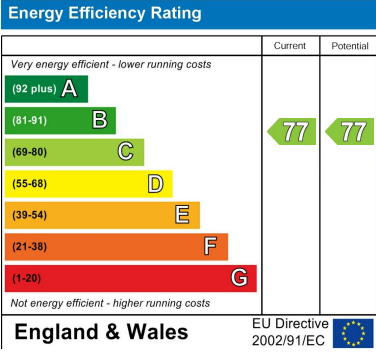

These particulars, whilst believed to be accurate are set out as a general outline only for guidance and do not constitute any part of an offer or contract. Intending purchasers should not rely on them as statements of representation of fact, but must satisfy themselves by inspection or otherwise as to their accuracy. No person in this firms employment has the authority to make or give any representation or warranty in respect of the property.